

Please read and save these instructions. Read carefully before attempting to assemble, install, operate or maintain the product described. Protect yourself and others by observing all safety information. Failure to comply with instructions could result in personal injury and/or property damage! Retain instructions for future reference.

Dayton® 8 & 12" Plate Shear

ENGLISH

Description

Dayton 8" (13W879) & 12" (13W871) Plate Brake is hand operated and capable of shearing mild steel plate up to 8" & 12" in length, 1/4" thick and bars up to 1/2" diameter. Blades are removable, can be re-sharpened or replaced. Construction is of cast iron base with tool steel blades. A material hold-down plate is included

Unpacking

Refer to Figure 1.

Check for shipping damage. If damage has occurred, a claim must be filed with carrier. Check for completeness. Immediately report missing parts to dealer.

The plate shear comes assembled as one unit. Additional parts which need to be fastened to the tool should be located and accounted for before assembling:

Handle and hold-down plate with hex nuts

IMPORTANT: Blades are coated with a protectant. To ensure proper fit and operation, remove coating. Coating is easily removed with mild solvents, such as mineral spirits, and a soft cloth. Avoid getting cleaning solution on paint or any of the rubber or plastic parts. Solvents may deteriorate these finishes. Use soap and water on paint, plastic or rubber components. After cleaning, cover all exposed surfaces with a light coating of oil.

⚠ WARNING *Never use highly volatile solvents. Non-flammable solvents are recommended to avoid possible fire hazard.*

Specifications

13W879

Maximum thickness.....1/4" mild steel
 Maximum length..... 8"
 Maximum bar diameter..... 1/2"
 Base dimensions..... 3 3/4 x 14"
 Mounting holes (7/16").... 2 1/2 x 12"
 Weight..... 38 lbs

13W871

Maximum thickness.....1/4" mild steel
 Maximum length..... 12"
 Maximum bar diameter..... 1/2"
 Base dimensions..... 3 5/8 x 18 1/4"
 Mounting holes (1/2")..... 60 x 420mm
 Weight..... 58 lbs

General Safety Information

⚠ WARNING *For your own safety, read all of the instruction and precautions before operation tool.*

⚠ CAUTION *Always follow proper operating procedures as defined in this manual even if you are familiar with use of this or similar tools. Remember that being careless for even a fraction of a second can result in severe personal injury.*

BE PREPARED FOR JOB

1. Wear proper apparel. Do not wear loose clothing, gloves, neckties, rings, bracelets or other jewelry which may get caught in moving parts of machine.
2. Wear protective hair covering to contain long hair.
3. Wear safety shoes with non-slip soles.
4. Wear safety glasses complying with United States ANSI Z87.1. Everyday glasses have only impact resistant lenses. They are NOT safety glasses.
5. Be alert and think clearly. Never operate tools when tired, intoxicated or when taking medications that cause drowsiness.

PREPARE WORK AREA FOR JOB

1. Keep work area clean. Cluttered work areas invite accidents.

2. Work area should be properly lighted.
3. Keep visitors at a safe distance from work area.
4. Keep children out of workplace. Make workshop childproof. Use padlocks to prevent any unintentional use of tools.

TOOL SHOULD BE MAINTAINED

1. Consult manual for specific maintaining and adjusting procedures.
2. Keep tool lubricated and clean for safest operation.
3. Remove adjusting tools. Form habit of checking to see that adjusting tools are removed before using machine.
4. Keep all parts in working order. Check to determine that the guard or other parts will operate properly and perform their intended function.
5. Check for damaged parts. Check for alignment of moving parts, binding, breakage, and mounting or any other condition that may affect a tool's operation.
6. A guard or other damaged part should be properly repaired or replaced. Do not perform makeshift repairs. (Use parts list provided to order repair parts.)

KNOW HOW TO USE TOOL

1. Use right tool for job. Do not force tool or attachment to do a job for which it was not designed.
2. Keep hands out of path of shear blades.
3. The maximum capacity of this machine is 1/4" mild steel or equivalent. Exceeding capacity may be dangerous to operator and damage may occur to the machine.
6. Bolt machine to floor or sturdy stand that is bolted to floor to prevent sliding or tipping of machine.

Dayton® 8 & 12" Plate Shear

ENGLISH

Assembly

Refer to Figure 1.

MOUNT HANDLE

Remove two hex head bolts (Ref. No. 11) from pivot arm (Ref. No. 9). Mount handle (Ref. No. 10) into groove on pivot arm. Secure handle with hex head bolts. Tighten bolts securely.

MOUNT HOLD-DOWN PLATE

Insert threaded rod of hold-down plate (Ref. No. 12) through hole in support block (Ref. No. 1).

Installation

Machine should be installed on a level surface, with proper lighting. Machine can be floor-mounted, stand-mounted or bench-mounted. Be sure to provide clearance for handle bar rotation. Use four mounting holes on the base to bolt machine securely to floor, bench or stand (fasteners not included).

Area around machine should be clear of scraps, oil or dirt. Apply a suitable non-skid material to floor.

Operation

Refer to Figure 1.

Rotating handle (Ref. No. 10) operates the shear. Be sure to keep hands clear of shear when rotating handle. The maximum capacity of the machines is ¼" mild steel.

SHEARING PLATE AND FLAT BARS

1. Adjust hold-down plate (Ref. No. 12) so that workpiece can lie horizontally between shear blades. Place workpiece between blades (Ref. Nos. 4 and 18) and underneath hold-down plate. Adjust hold-down plate to be positioned at the top surface of the workpiece, with the workpiece held horizontally. Secure the hold-down plate in position by tightening it.
2. Support workpiece between blades and underneath the hold down plate at position where cut is desired. Pull handles (Ref. No. 10) forward with both hands until blade cuts through workpiece.

CAUTION *Do not reach in back of shear to grasp fall out piece*

Shear thicker material is done by "snapping" crank handles so that upper blade impacts workpiece. Upper blade is mounted at an angle so that workpiece can be sheared in small increments. To minimize distortion, approximately 5/8" of workpiece should be sheared with each impact.

SHEARING ROUND BARS

Round bars up to ½" diameter can be cut with this shear.

Place bar through holes in face of upper blade (Ref. No. 4) and die (Ref. No. 20). Position bar where cut is desired and pull handle (Ref. No. 10) forward until bar is cut.

MAINTENANCE

Refer to Figure 1.

LUBRICATION

All exposed iron surfaces should be coated with light oil to prevent rusting.

SHEAR BLADES

Always keep shear blades lubricated and clean of any dirt or rust. Abrasive particles on blades will drastically reduce life of blades. These blades should be sharpened according to industry standards by a competent grinding service only.

Troubleshooting Chart

Symptom	Possible Cause(s)	Corrective Action
Machine will Not shear	1. Workpiece material too thick 2. Blades too far apart or not parallel 3. Dull blades	1. Do not exceed machine capacity of ¼" mild steel 2. Make sure hold-down plate (Ref. No. 12) are tight and hold lower blade securely 3. Have blades sharpened by a qualified grinding service

For Repair Parts, call 1-800-323-0620

24 hours a day – 365 days a year

Please provide following information:

- Model number
- Serial number (if any)
- Part description and number as shown in parts list

E
N
G
L
I
S
H

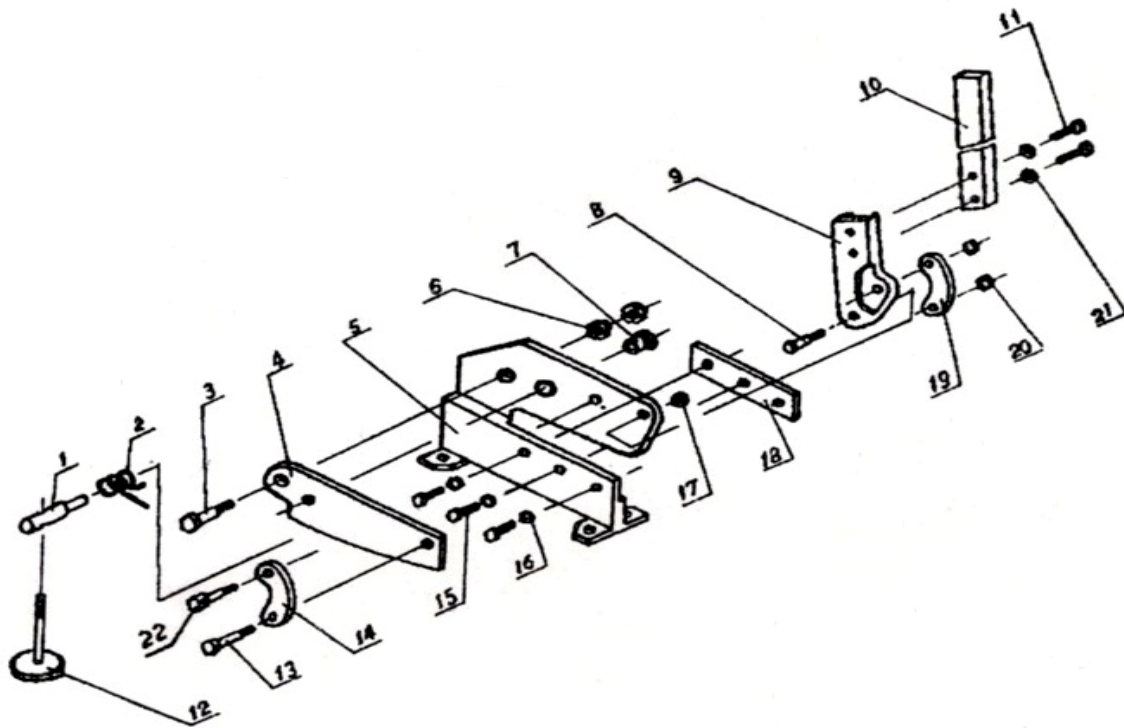

Figure 1 – Repair Parts Illustration for Plate Shear

Repair Parts List for 8 & 12" Plate Shear

E
N
G
L
I
S
H

Ref. No.	Description	13W897	QTY
1	Support Block	†	1
2	Spring	TT3HS08002G	1
3	Bolt M14X50mm	*	1
4	Upper blade	TT3HS08004G	1
5	Base	†	1
6	Nut M14	*	2
7	Die	†	1
8	Bolt M10X47mm	*	1
9	Pivot arm	†	1
10	Handle	TT3HS08010G	1
11	Bolt M10X40mm	*	2
12	Hold down Plate	†	1
13	Screw M8X40mm	*	1
14	Left Link	†	1
15	Screw M10X22mm	*	3
16	Washer 10mm		3
17	Nut M10	TT3HS08017G	2
18	Lower blade	TT3HS08018G	1
19	Right Link	†	1
20	Nut M8	*	4
21	Washer 10mm	*	2
22	Bolt M8X40mm	TT3HS08022G	1

Ref. No.	Description	13W871	QTY
1	Support Block	†	1
2	Spring	TT3HS12002G	1
3	Bolt M18X50mm	*	1
4	Upper blade	TT3HS12004G	1
5	Base	†	1
6	Nut M18	*	2
7	Die	†	1
8	Bolt M10X50mm	*	1
9	Pivot arm	†	1
10	Handle	TT3HS12010G	1
11	Bolt M12X40mm	*	2
12	Hold down Plate	*	1
13	Screw M14X57mm	*	1
14	Left Link	†	1
15	Screw M12X22mm	*	4
16	Washer 12mm	*	4
17	Nut M10	TT3HS12017G	2
18	Lower blade	TT3HS12018G	1
19	Right Link	†	1
20	Nut M14	*	4
21	Washer 12mm	*	2
22	Bolt M14X57	TT3HS12022G	1

(†) Not available as repair part.

(*) Standard hardware item, available locally.

Dayton[®] 8 & 12" Plate Shear

LIMITED WARRANTY

DAYTON ONE-YEAR LIMITED WARRANTY.

DAYTON[®] 8 & 12" PLATE SHEAR, MODELS COVERED IN THIS MANUAL, ARE WARRANTED BY DAYTON ELECTRIC MFG. CO. (DAYTON) TO THE ORIGINAL USER AGAINST DEFECTS IN WORKMANSHIP OR MATERIALS UNDER NORMAL USE FOR ONE YEAR AFTER DATE OF PURCHASE. ANY PART WHICH IS DETERMINED TO BE DEFECTIVE IN MATERIAL OR WORKMANSHIP AND RETURNED TO AN AUTHORIZED SERVICE LOCATION, AS DAYTON DESIGNATES, SHIPPING COSTS PREPAID, WILL BE, AS THE EXCLUSIVE REMEDY, REPAIRED OR REPLACED AT DAYTON'S OPTION. FOR LIMITED WARRANTY CLAIM PROCEDURES, SEE "PROMPT DISPOSITION" BELOW. THIS LIMITED WARRANTY GIVES PURCHASERS SPECIFIC LEGAL RIGHTS WHICH VARY FROM JURISDICTION TO JURISDICTION.

LIMITATION OF LIABILITY. TO THE EXTENT ALLOWABLE UNDER APPLICABLE LAW, DAYTON'S LIABILITY FOR CONSEQUENTIAL AND INCIDENTAL DAMAGES IS EXPRESSLY DISCLAIMED. DAYTON'S LIABILITY IN ALL EVENTS IS LIMITED TO AND SHALL NOT EXCEED THE PURCHASE PRICE PAID.

WARRANTY DISCLAIMER. A DILIGENT EFFORT HAS BEEN MADE TO PROVIDE PRODUCT INFORMATION AND ILLUSTRATE THE PRODUCTS IN THIS LITERATURE ACCURATELY; HOWEVER, SUCH INFORMATION AND ILLUSTRATIONS ARE FOR THE SOLE PURPOSE OF IDENTIFICATION, AND DO NOT EXPRESS OR IMPLY A WARRANTY THAT THE PRODUCTS ARE MERCHANTABLE, OR FIT FOR A PARTICULAR PURPOSE, OR THAT THE PRODUCTS WILL NECESSARILY CONFORM TO THE ILLUSTRATIONS OR DESCRIPTIONS. EXCEPT AS PROVIDED BELOW, NO WARRANTY OR AFFIRMATION OF FACT, EXPRESSED OR IMPLIED, OTHER THAN AS STATED IN THE "LIMITED WARRANTY" ABOVE IS MADE OR AUTHORIZED BY DAYTON.

Technical Advice and Recommendations, Disclaimer. Notwithstanding any past practice or dealings or trade custom, sales shall not include the furnishing of technical advice or assistance or system design. Dayton assumes no obligations or liability on account of any unauthorized recommendations, opinions or advice as to the choice, installation or use of products.

Product Suitability. Many jurisdictions have codes and regulations governing sales, construction, installation, and/or use of products for certain purposes, which may vary from those in neighboring areas. While attempts are made to assure that Dayton products comply with such codes, Dayton cannot guarantee compliance, and cannot be responsible for how the product is installed or used. Before purchase and use of a product, review the product applications, and all applicable national and local codes and regulations, and be sure that the product, installation, and use will comply with them.

Certain aspects of disclaimers are not applicable to consumer products; e.g., (a) some jurisdictions do not allow the exclusion or limitation of incidental or consequential damages, so the above limitation or exclusion may not apply to you; (b) also, some jurisdictions do not allow a limitation on how long an implied warranty lasts, consequently the above limitation may not apply to you; and (c) by law, during the period of this Limited Warranty, any implied warranties of implied merchantability or fitness for a particular purpose applicable to consumer products purchased by consumers, may not be excluded or otherwise disclaimed.

Prompt Disposition. A good faith effort will be made for prompt correction or other adjustment with respect to any product which proves to be defective within limited warranty. For any product believed to be defective within limited warranty, first write or call dealer from whom the product was purchased. Dealer will give additional directions. If unable to resolve satisfactorily, write to Dayton at address below, giving dealer's name, address, date, and number of dealer's invoice, and describing the nature of the defect. Title and risk of loss pass to buyer on delivery to common carrier. If product was damaged in transit to you, file claim with carrier.

Manufactured for Dayton Electric Mfg. Co., 5959 W. Howard St., Niles, Illinois 60714-4014 U.S.A.